

型号 756 - 5□'

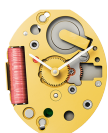

产品规格

指针式石英机芯

系列

标准系列

型号

756

尺寸

5□'

版本 瑞士制造

4 钻石 / 金色

版本 瑞士零件 远东组装

1 钻石 / 银色

电池寿命

7 年

标准针高

1

特点

- 特长电池寿命
- 金属机芯，可修理
- 多种不同针高选择
- 电子按钮设定时间
短按 - 设定分钟
稍长按 - 设定小时
连续长按 - 时间持续前进直至放开按钮

功能

- 电子按钮设定时间
- 两针

Quartz Movements

经典功能

朗达 标准系列

型号 756 - 5□'

技术规格

机芯直径	13.00 mm
内罩座位直径	13.00 mm
机芯厚度	3.10 mm
电池以上厚度	3.10 mm
机芯座位	0.40 mm
把中	0.00 mm
把心行程	0.00 mm
把心螺纹直径	0.00 mm
分针运行扭力 - 一般情况下	30 μ Nm
运作温度	0 - 50 °C
误差率	-10 / +20 秒/月
防磁度	18.8 Oe
防震度	NIHS 91-10

电池规格

电池类型	型号 379
电池寿命	7 年
电压	1.5 V
电耗 - 一般情况下	0.34 μ A
电耗 - 上限	0.4 μ A

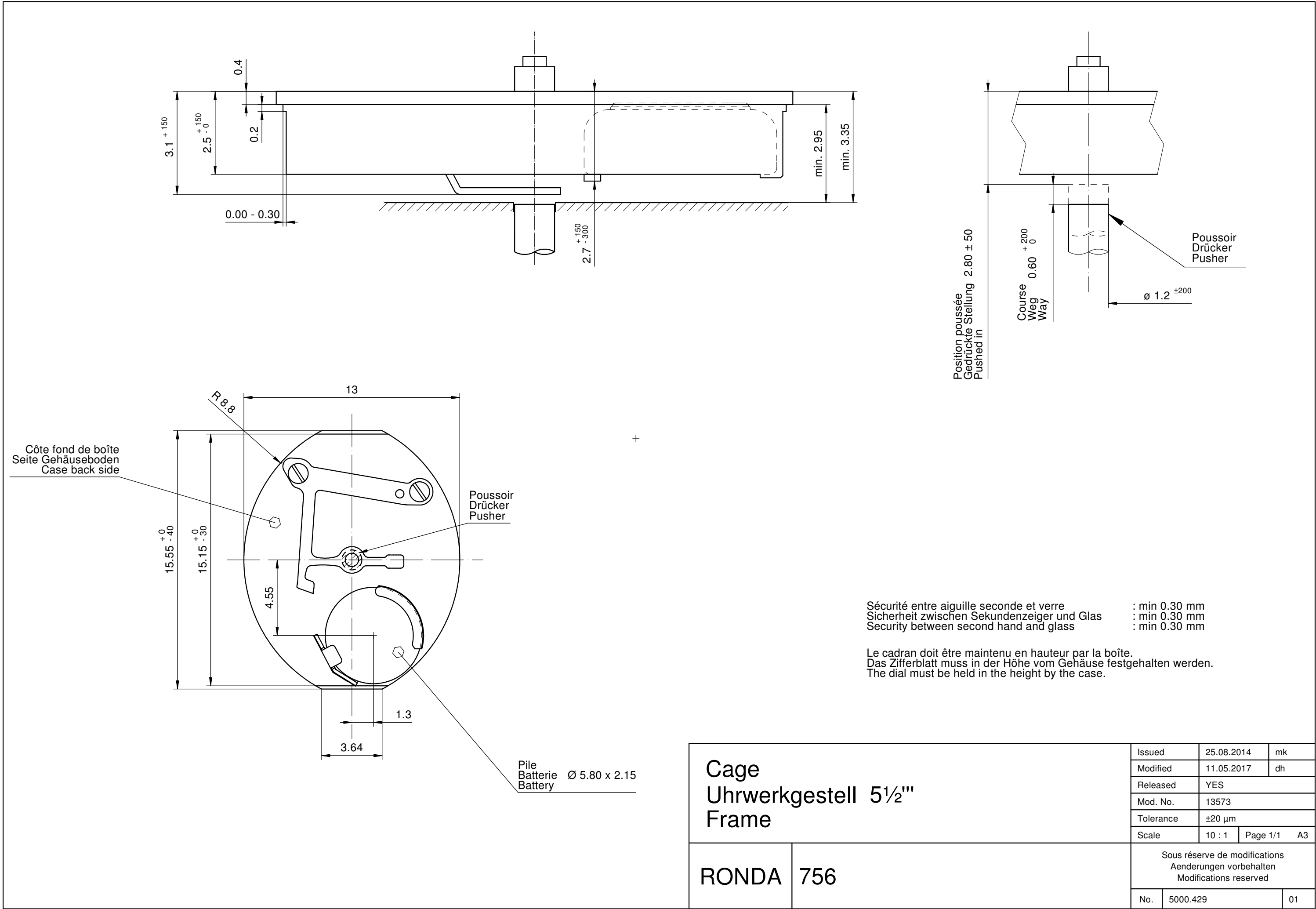

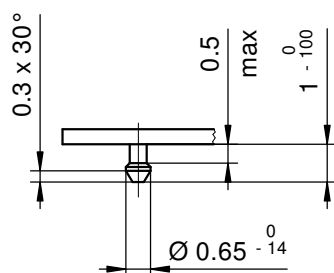
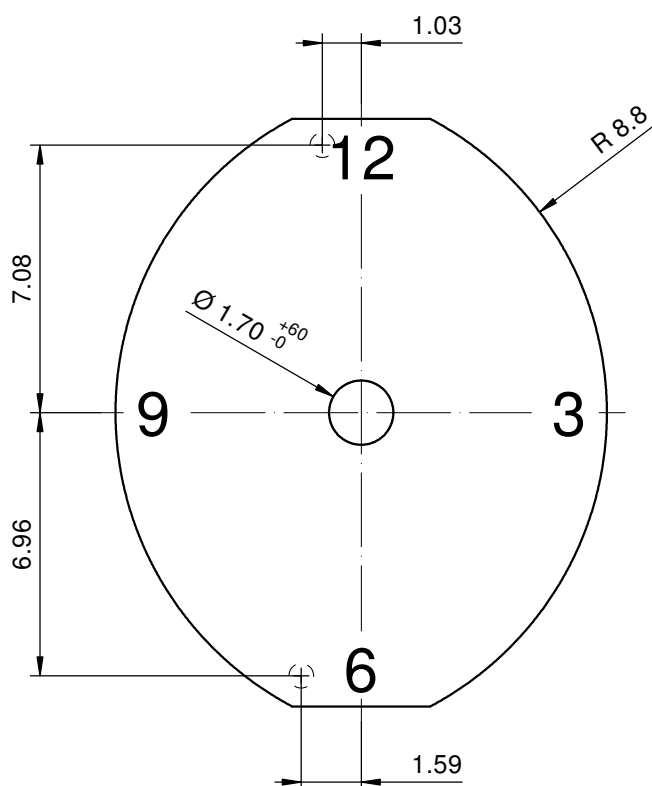

Epaisseur du cadran selon hauteur de l'aiguillage
Zifferblattdicke gemäss Zeigerwerkhöhen
Dial thickness according to hand fitting heights

Cadran
Zifferblatt 5 1/2"
Dial

Issued	06 Jan 2016	dh
Modified	17 Okt 2016 ÄÄ 13573	dh
Released	YES	
Tolerance	+/- 20 µm	
Scale	5 : 1 (A4V)	

RONDA

756

Sous réserve de modifications
Änderungen vorbehalten
Modifications reserved

No.	5010.798	01
-----	----------	----

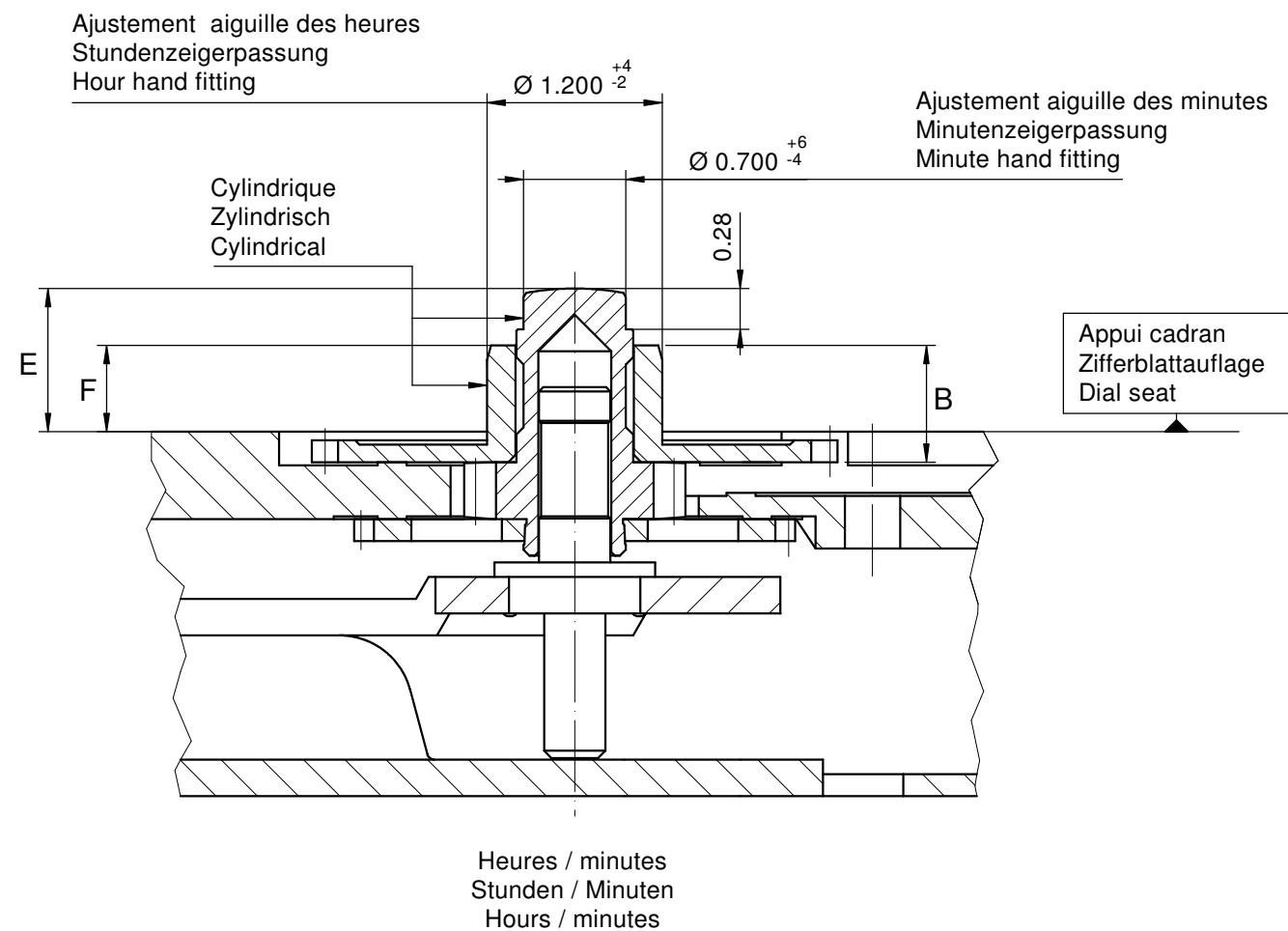

Aiguillage no Zeigerwerkhöhe Nr. Hand fitting height No	Dépassement Höhe über Zifferblattaufgabe Height over dial seat			Longueur Länge Length		Epaisseur max. (peinture comprise) Max. Dicke (inkl. Farbe) Max. thickness (paint included)			
	Chaussée Minutenrohr Cannon-pinion	Roue des heures Stundenrad Hour wheel		Roue des heures Stundenrad Hour wheel		Cadran Zifferblatt Dial			Aiguilles Zeiger Hands
						Sous l'aiguille des minutes Unter Minutenzeiger Under minute hand	Sous l'aiguille des heures Unter Stundenzeiger Under hour hand		
	E	F		B					
0	0.95	0.60		0.80		0.50	0.30		0.15
1	1.10	0.75		0.95		0.65	0.40		0.15
2	1.30	0.95		1.15		0.85	0.60		0.15
3	1.80	1.35		1.57		1.35	1.00		0.15
4	2.70	2.35		2.55		2.25	2.00		0.15
5	3.30	2.95		3.15		2.85	2.60		0.15

		Aig. des minutes Minutenzeiger Minute hand	Aig. des heures Stundenzeiger Hour hand	Lors de la pose d'aiguilles, le mouvement doit être soutenu. Beim Zeigersetzen muss das Werk abgestützt werden. The movement needs to be supported for hand setting.
mg	max.	30	30	Masse / Masse / Weight *
µNm	max.	0.14	0.14	Balourd / Unwucht / Unbalance *
gmm ²	max.	-	-	Inertie / Massenträgheit / Inertia *
N	max.	40	40	Force de chassage / Aufpresskraft / Force

Aiguillages Zeigerwerkhöhen 5½", 6¾ x 8" Hand fitting heights

RONDA

751, 756, 762, 762E

Issued	18 Feb 2001	mk
Modified	06 Jan 2016 ÄA 13573	dh
Released	Yes	
Tolerance	µm	
Scale	20 : 1 (A3H)	
Sous réserve de modifications Änderungen vorbehalten Modifications reserved		
No.	3316.002	20

User's Manual English

Movement Caliber

RONDA normtech

– 756

You have decided to buy a watch, which was assembled by a watchmaker using a Ronda movement. Please note that no watches are produced or distributed under the Ronda brand.

In case of repairs, guarantee claims and questions concerning the functioning of a watch, purchasers and consumers should contact their retailer or the watch manufacturer, for which the relevant information can be found in the sales or guarantee documentation provided with the watch.



ETS

Cal. 756

ETS – Electronic time setting on case back

1. brief pressure up to two seconds: minute correction
2. medium pressure between two and four seconds: hour correction
3. Pressure more than four seconds: continuous correction until corrector is released





Cal. 756

Battery type: 379/SR521SW

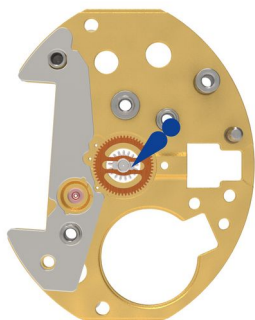

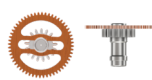

Precision: +20/-10 seconds per month



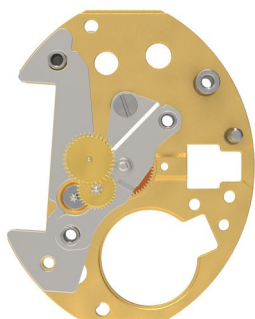



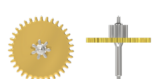

- | | | | |
|---|-----------------------------------------------------------------------------------|------------------|----------------------|
| 1 |  | 2000.365.SM.G.LC | Main plate |
| 2 |  | 3622.018 | Stator |
| 3 |  | 3305.174.CO | Cannon pinion (Aig.) |
| 4 |  | J124 | Jismaa 124 |

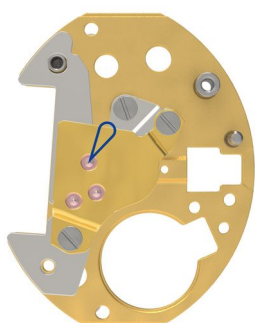

- | | | | |
|---|-------------------------------------------------------------------------------------|-------------|--------------------|
| 5 |  | 2020.104.CO | Center bridge |
| 6 |  | 4000.141 | Screw |
| 7 |  | 3715.100.RK | Rotor |
| 8 |  | 3147.020.CO | Intermediate wheel |
| 9 |  | 3122.045.CO | Third wheel |



- | | | | |
|----|-------------------------------------------------------------------------------------|----------------|--------------------|
| 10 |  | 2020.116.G.M25 | Train wheel bridge |
| 11 |  | 4000.141 | Screw |
| 12 |  | 4000.141 | Screw |
| 13 |  | 9014 | Moebius 9014 |

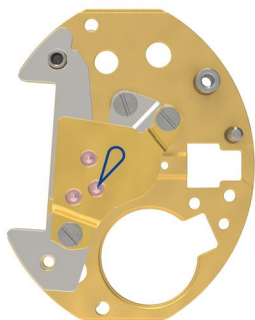

14



9014

Moebius 9014

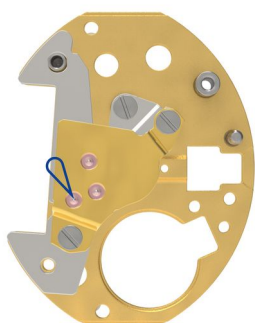

15



9014

Moebius 9014



16



3621.061.RK

Coil

Attention: Please hold the coil only on the grey coil core.

17



3601.039.G

Battery clamp (+)

18



4000.243

Screw



19



9014

Moebius 9014

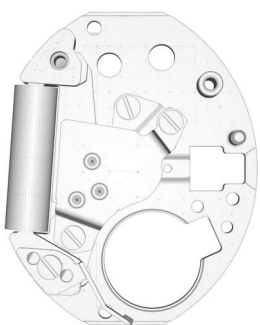

20

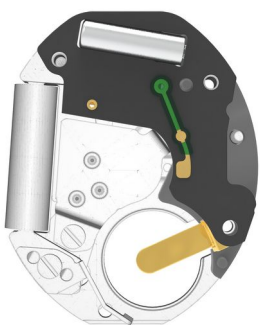

21



3603.103

Insulator

22



3601.047

Contact strip (-)





23



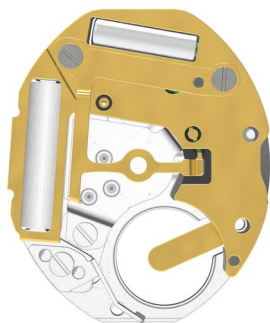

3612.252

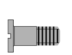
Electronic module







- | | | | |
|----|-----------------------------------------------------------------------------------|----------------|---------------------------|
| 24 |  | 2130.251.G.M01 | Module cover plate |
| 25 |  | 3601.162.G | Contact spring for pusher |
| 26 |  | 4000.343 | Screw |
| 27 |  | 4000.343 | Screw |

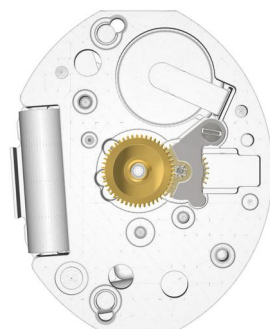

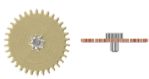
- | | | | |
|----|------------------------------------------------------------------------------------|--------------|-----------------------------|
| 28 |  | 3600.018.HGF | Battery 379 (Ø 5.80 x 2.15) |
| 29 |  | 3601.171.G | Battery clamp |
| 30 |  | 4000.375 | Screw |



- | | | | |
|----|-------------------------------------------------------------------------------------|-------------|-------------------|
| 31 |  | 3007.052.CO | Minute wheel |
| 32 |  | 2130.041 | Plate |
| 33 |  | 4000.169 | Screw |
| 34 |  | 3301.133.TA | Hour wheel (Aig.) |
| 35 |  | 3315.001 | Friction spring |

Measurement

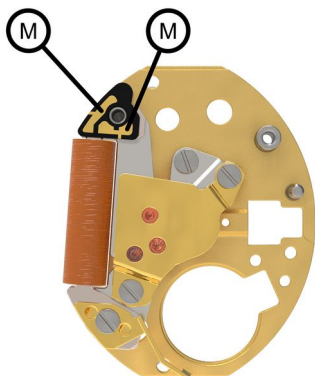

Signal generator (4.9ms, 8Hz)
< 1.20 V

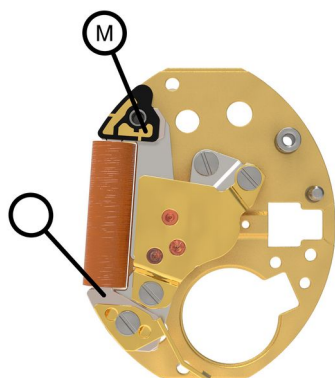

Coil insulation
infinite

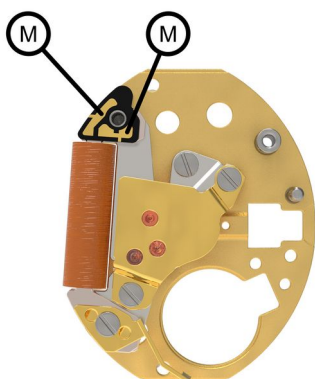

Coil resistance movement
(min./max) 1425 - 1575 Ohm

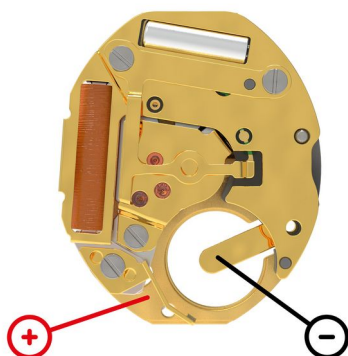

Lower working voltage limit
 $<1.20\text{ V}$

60s measuring interval
 $-10 \dots +20\text{s/mth}$

60s measuring interval
 (typ./max.) $0.34 / 0.40\text{ }\mu\text{A}$

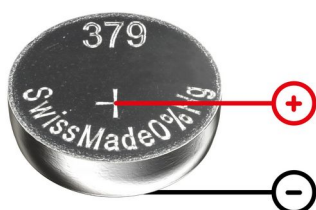

Voltage
 typ. 1.5 V