

## Caliber 7002.B – 15"



### Product Specifications

Analog quartz movement

Line xtratech

Caliber 7002.B

Size 15"

Version Swiss Made 5 Jewels / gold plated

Standard battery life 52 months

Standard hand fitting height 1

### Features

- Repairable metal watch movement
- Power saving mechanism with pulled out stem:  
Reduction of consumption approximately 70%
- Big date with quick change

### Functions

- Multifunction
- Big date
- 2 hands

# Quartz Movements Multifunctions RONDA xtratech

## Caliber 7002.B – 15"

### Technical Specifications

Diameter Total	34.60 mm
Case fitting	33.80 mm
Movement height	5.60 mm
Height over standard battery	5.60 mm
Movement rest	0.60 mm
Height over stem	3.30 mm
Length of stem travel	1.00 mm
Force to push the stem for screwed crown	10 / 15 N
Stem thread	0.90 mm
Useful torque minute – typical	500 $\mu$ Nm
Operating temperature	0 - 50 °C
Instantaneous rate	-10/ +20 sec/month
Resistance to magnetic fields	18.8 Oe
Resistance against shock	NIHS 91-10

### Battery Specifications

Standard battery	No. 381
Standard battery life	52 months
Battery voltage	1.5 V
Current consumption – typical	1.32 $\mu$ A (Date Mechanism not in Gear)
Current consumption – maximum	3.1 $\mu$ A (Date Mechanism not in Gear)

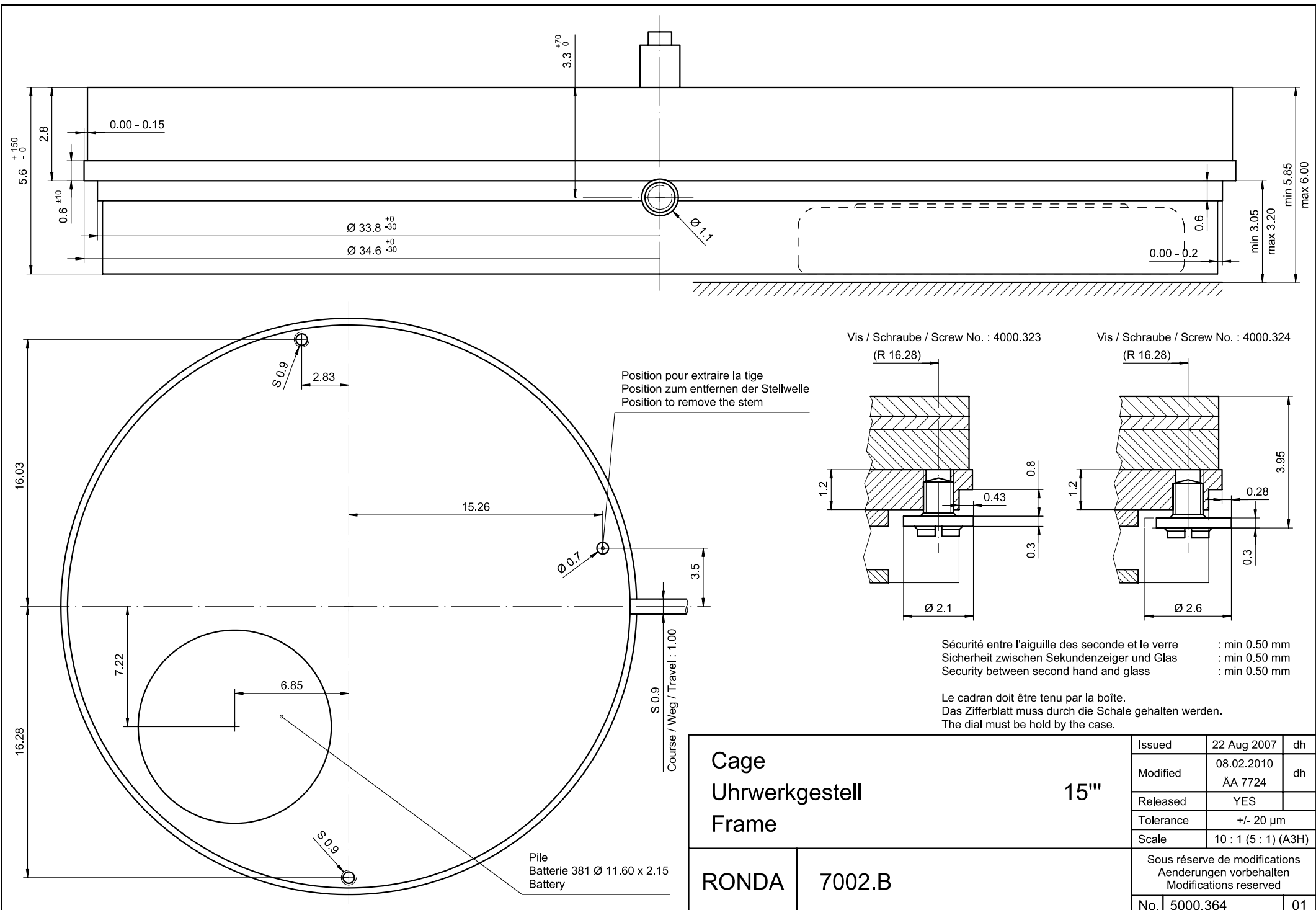

Cage Uhrwerkgestell Frame  15"		Issued	22 Aug 2007	dh
		Modified	08.02.2010 ÅA 7724	dh
		Released	YES	
		Tolerance	+/- 20 µm	
		Scale	10 : 1 (5 : 1) (A3H)	
RONDA	7002.B	Sous réserve de modifications Änderungen vorbehalten Modifications reserved		
		No.	5000.364	01

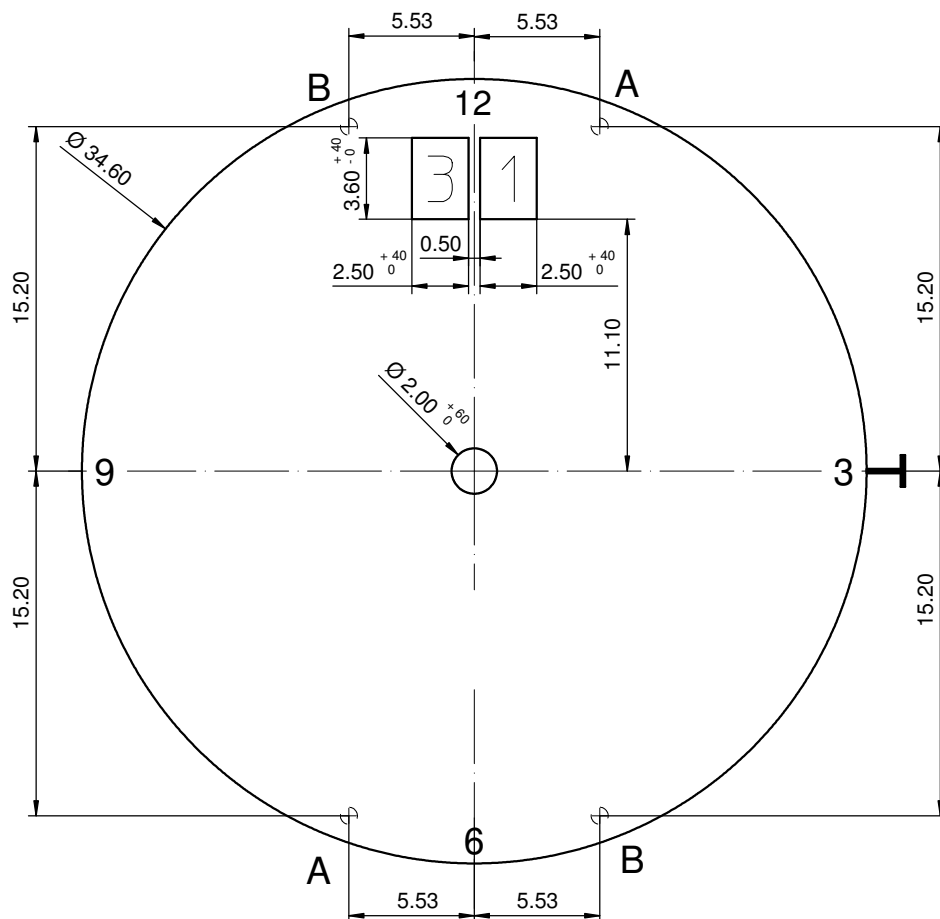

Disponibeles positions pour pieds de cadran / Available dial feet positions / Verfügbare Zifferblatffusspositionen

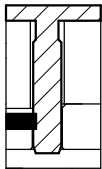
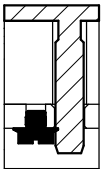
A Pos 1h / 7h	B Pos 5h / 11h
 <p>Fixation du cadran avec rondelle en plastique Dial fixation by plastic disc Zifferblattbefestigung durch Kunststoffscheibe</p>	 <p>Fixation du cadran avec clef de cadran Dial fixation by dial - key Zifferblattbefestigung durch Zifferblattschlüssel</p>

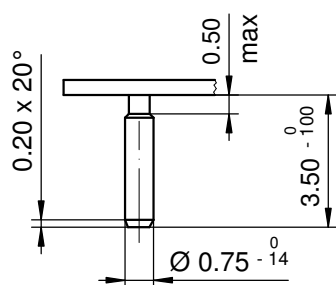

Epaisseur du cadran selon hauteur de l'aiguillage  
Zifferblattdicke gemäss Zeigerwerkhöhen  
Dial thickness according to hand fitting heights

Tige	Date
Stellw.	Datum
Stem	Date
3H	12H

Cadran  
Zifferblatt  
Dial

15"

Issued	22 Aug 2007	dh
Modified	26 Nov 2012 ÄÄ 10475	dh
Released	YES	
Tolerance	+/- 20 µm	
Scale	3 : 1 (A4V)	

RONDA

7002.B, 7003.B

Sous réserve de modifications  
Änderungenvorbehalten  
Modifications reserved

No.	5010.637	01
-----	----------	----

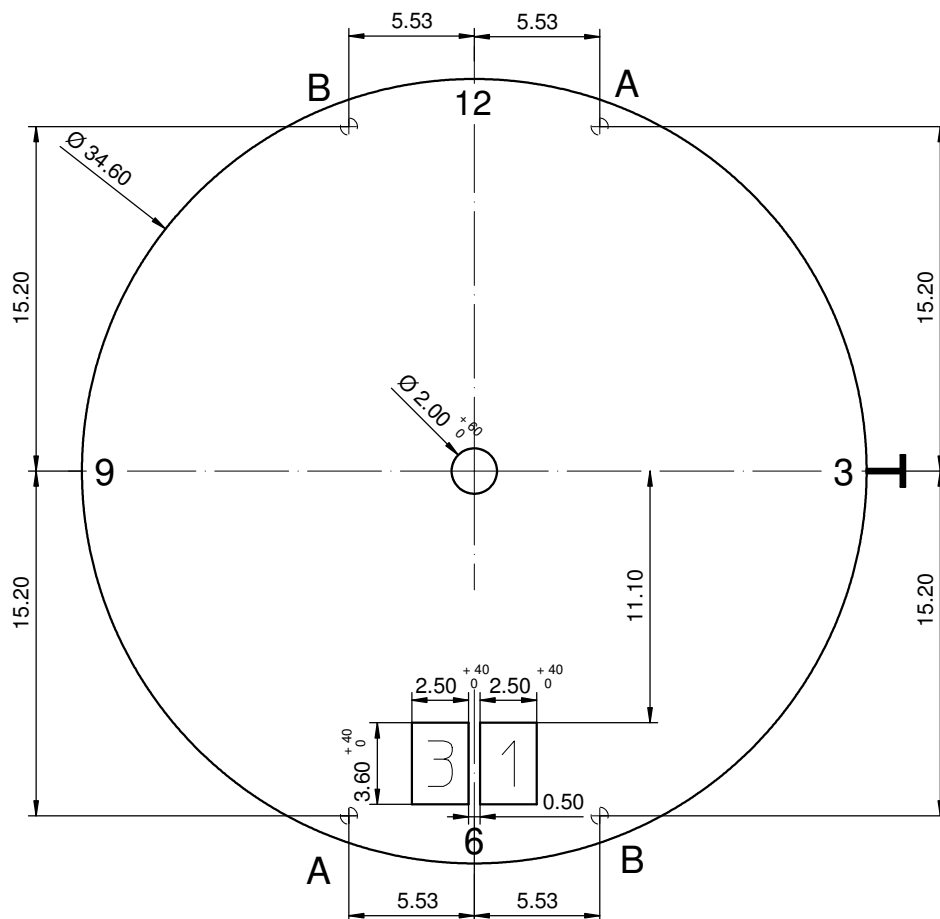

Disponibiles positions pour pieds de cadran / Available dial feet positions / Verfügbare Zifferblatfußpositionen

A Pos 1h / 7h	B Pos 5h / 11h
<p>Fixation du cadran avec rondelle en plastique Dial fixation by plastic disc Zifferblattbefestigung durch Kunststoffscheibe</p>	<p>Fixation du cadran avec clef de cadran Dial fixation by dial - key Zifferblattbefestigung durch Zifferblattschlüssel</p>

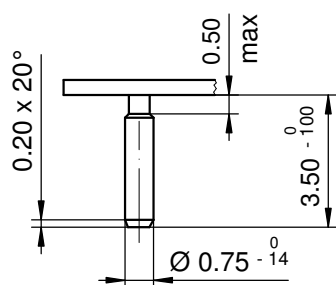

Epaisseur du cadran selon hauteur de l'aiguillage  
Zifferblattdicke gemäss Zeigerwerkhöhen  
Dial thickness according to hand fitting heights

Tige	Date
Stellw.	Datum
Stem	Date
3H	6H

Cadran  
Zifferblatt  
Dial

15"

Issued	22 Aug 2007	dh
Modified	26 Nov 2012 ÄÄ 10475	dh
Released	YES	
Tolerance	+/- 20 µm	
Scale	3 : 1 (A4V)	

RONDA

7002.B, 7003.B

Sous réserve de modifications  
Änderungenvorbehalten  
Modifications reserved

No.	5010.638	01
-----	----------	----

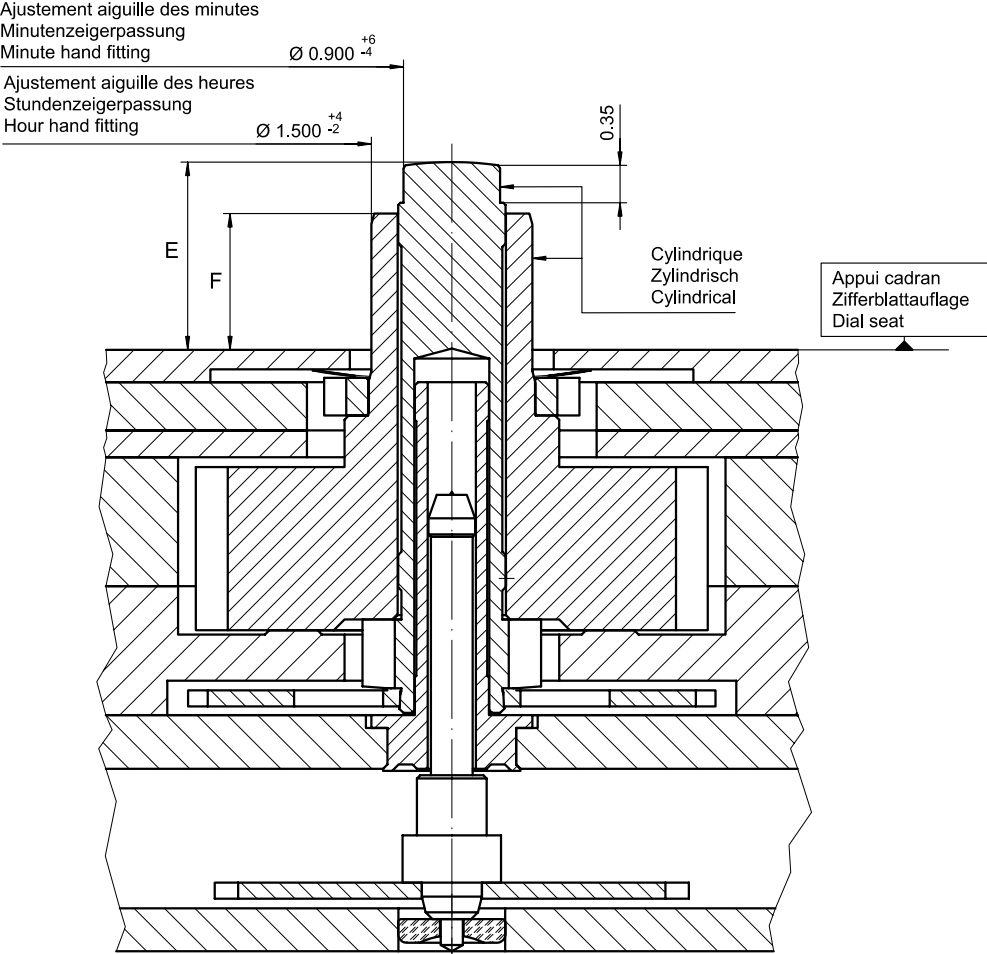

Heures / minutes  
Stunden / Minuten  
Hours / minutes

		Alg. des minutes Minutenzeiger Minute hand	Alg. des heures Stundenzeiger Hour hand	Lors de la pose d'aiguilles, le mouvement doit être soutenu. Beim Zeigersetzen muss das Werk abgestützt werden. The movement needs to be supported for hand setting.
mg	max.	30	30	Masse / Masse / Weight *
µNm	max.	0.70	0.70	Balourd / Unwucht / Unbalance *
gmm <sup>2</sup>	max.	-	-	Inertie / Massenträgheit / Inertia *
N	max.	40	40	Force de chassage / Aufpresskraft / Force

Aiguillages Zeigerwerkhöhe Hand fitting height		
Dépassement Höhe über Zifferblattauflage Height over dial seat		
No	Chaussée Minutenrohr Cannon-pinion	Roue des heures Stundenrad Hour wheel
1	E	F
-		

Aiguillages Zeigerwerkhöhe Hand fitting height			
Peinture comprise / inkl. Farbe / Paint included			
Epaisseur maximum du cadran Maximale Zifferblattdicke Maximum dial thickness			Epaisseur des aiguilles Zeigerdicke Hands thickness
No	Sous l'aiguille des minutes Unter Minutenzeiger Under minute hand	Sous l'aiguille des heures Unter Stundenzeiger Under hour hand	
1	1.30	0.85	0.15
-			

Sous réserve de toutes modifications		Änderungen vorbehalten		All modifications reserved	
Aiguillages Zeigerwerkhöhen Hand fitting heights		15"		Issued	22 Aug 2007
				Modified	02.08.2010 ÄA 2120
				Released	YES
				Tolerance	µm
				Scale	20:1 (A3H)
RONDA		7002.B		Sous réserve de modifications Änderungen vorbehalten Modifications reserved	
				No.	3316.117
					02

\* En cas de données différentes, veuillez contacter le service après-vente

\* Bei abweichenden Werten, bitte technischen Kundendienst anfragen

\* In case of different values, please contact the customer service



Tige de travail (intégrée dans le mouvement)  
Arbeitsstellwelle (im Werk eingebaut)  
Working stem (implemented in the movement)

No. d'article Artikelnummer Part number	L	L1	L2	L3	S	D
3000.194.CO	21.30	10.74	27.64	10.15	0.90	1.10



Couleur de la couronne Kronenfarbe Crown color	violet violett purple
Code	UN 5046

Tige (normale) / Stellwelle (normal) / Stem (normal)

No. d'article Artikelnummer Part number	L	L1	L2	L3	S	D
3000.194	21.30	10.74	27.64	10.15	0.90	1.10



Couronne normale  
Normale Krone  
Normal crown

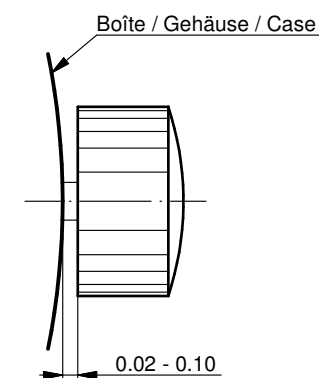

Couronne vissée  
Geschraubte Krone  
Screwed crown

Force ⇐ min. Kraft ⇐ min. Force ⇐ min.	10 N
Force ⇐ max. Kraft ⇐ max. Force ⇐ max.	15 N

Rallonge de tige / Stellwelle Verlängerung / Stem extension

No. d'article Artikelnummer Part number	L4	L5 (min)	L6	S1	S2	D1
3000.040	12.00	1.90	2.60	0.90	0.90	1.35

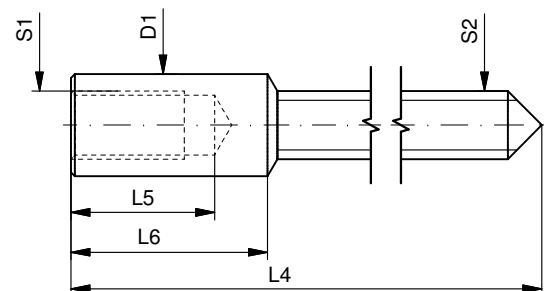

Tige (dimensions / forces)  
Stellwelle (Dimensionen / Kräfte)  
Stem (dimensions / forces)

RONDA

7002.B, 7003.B, 7003.L, 7003.N,  
7004.B, 7004.N, 7004.P

Issued	06 Sep 2012	ds5222
Modified	17 Mär 2017 ÄA 34582	mg5224
Released	YES	
Tolerance	---	
Scale	10:1 (A3)	
Sous réserve de modifications Änderungen vorbehalten Modifications reserved		
No.	5030.022	02

User's Manual English  
Movements Caliber

RONDA powertech

- 585
- 505
- 515

RONDA normtech

- 774 - 6003.D
- 775 - 6004.D
- 704
- 705
- 784
- 785
- 714
- 715
- 715Li

RONDA slimtech

- 1005
- 1006
- 1009
- 1015
- 1016
- 1019

RONDA xtratech

- 6003.B
- 6004.B
- 7002.B
- 7003.B
- 7004.B

You have decided to buy a watch, which was assembled by a watchmaker using a Ronda movement. Please note that no watches are produced or distributed under the Ronda brand.

In case of repairs, guarantee claims and questions concerning the functioning of a watch, purchasers and consumers should contact their retailer or the watch manufacturer, for which the relevant information can be found in the sales or guarantee documentation provided with the watch.

Cal. 585 / 785:  
Battery type: 362/SR721SW

Cal. 774 / 775 / 784:  
Battery type: 364/SR621SW

Cal. 505 / 515 / 704 / 705 / 714 / 715:  
Battery type: 371/SR920SW

Cal. 6003.D / 6004.D / 6003.B / 6004.B:  
Battery type: 373/SR916SW

Cal. 1005 / 1006 / 1009 / 1015 / 1016 / 1019:  
Battery type: 341/SR714SW

Cal. 7002.B / 7003.B / 7004.B:  
Battery type: 381/SR1120SW

Cal. 715Li:  
Battery type: CR 2016

Precision: +20/-10 seconds per month

Cal. 585	Cal. 6003.D
Cal. 505	Cal. 6004.D
Cal. 515	Cal. 6003.B
	Cal. 6004.B

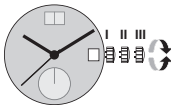

- Pos. I Position of rest (watch running)**
- Pos. II Quick-change correction for date**  
*The date can also be corrected during the day-changing phase between 10 pm and midnight. The date of the following day has to be set, because no automatic date change takes place at midnight.*
- Pull the crown out to position II (watch still running).
  - Turn the crown clockwise until the required date appears.  
*Cal. 6003.D & 6004.D:*
  - Turn the crown until the required date appears.
  - Push the crown back into position I.
- Pos. III Setting the time**
- Pull the crown out to position III (watch stopped).
  - Turn the crown, until the current time is displayed (remember the 24-hour cycle).
  - Push the crown back into position I.

Cal. 774	Cal. 715Li
Cal. 775	
Cal. 704	Cal. 1005
Cal. 705	Cal. 1006
Cal. 784	Cal. 1009
Cal. 785	Cal. 1015
Cal. 714	Cal. 1016
Cal. 715	Cal. 1019

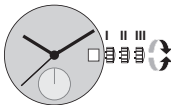

- Pos. I Position of rest (watch running)**
- Pos. II Quick-change correction for date**  
*Blocking time for the quick-change day correction is from approx. 9.30 pm and midnight.*
- Pull the crown out to position II (watch still running).
  - Turn the crown until the current date appears.
  - Push the crown back into position I.
- Pos. III Setting the time**
- Pull the crown out to position III (watch stopped).
  - Turn the crown, until the current time is displayed (remember the 24-hour cycle).
  - Push the crown back into position I.

Cal. 7002.B
Cal. 7003.B
Cal. 7004.B

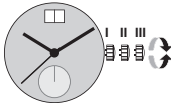

- Pos. I Position of rest (watch running)**
- Pos. II Quick-change correction for date**  
*The date can also be changed during the day-changing phase between approx. 8.00 pm and midnight. The date of the following day has to be set, because no automatic date change takes place at midnight.*
- Pull the crown out to position II (watch still running).
  - Turn the crown until the current date appears.
  - Push the crown back into position I.
- Pos. III Setting the time**
- Pull the crown out to position III (watch stopped).
  - Turn the crown, until the current time is displayed (remember the 24-hour cycle).
  - Push the crown back into position I.