

## Caliber 756 – 5½"

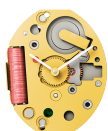

### Product Specifications

Analog quartz movement

Line	normtech
Caliber	756
Size	5½"
Version Swiss Made	4 Jewels / gold plated
Version Swiss Parts	1 Jewels / nickel plated
Standard battery life	7 Years
Standard hand fitting height	1

### Features

- Very long battery life
- Repairable metal watch movement
- Many high hand heights available
- Electronic Time Setting:<br>brief pressure up to two seconds - minute correction<br>medium pressure between two and four seconds - hour correction<br>Pressure more than four seconds - continuous correction until corrector is released

### Functions

- Electronic time setting
- 2 hands

## Caliber 756 – 5½"

### Technical Specifications

Diameter Total	13.00 mm
Case fitting	13.00 mm
Movement height	3.10 mm
Height over standard battery	3.10 mm
Movement rest	0.40 mm
Height over stem	0.00 mm
Length of stem travel	0.00 mm
Stem thread	0.00 mm
Useful torque minute – typical	30 µNm
Operating temperature	0 - 50 °C
Instantaneous rate	-10 / +20 sec/month
Resistance to magnetic fields	18.8 Oe
Resistance against shock	NIHS 91-10

### Battery Specifications

Standard battery	No. 379
Standard battery life	7 Years
Battery voltage	1.5 V
Current consumption – typical	0.34 µA
Current consumption – maximum	0.4 µA

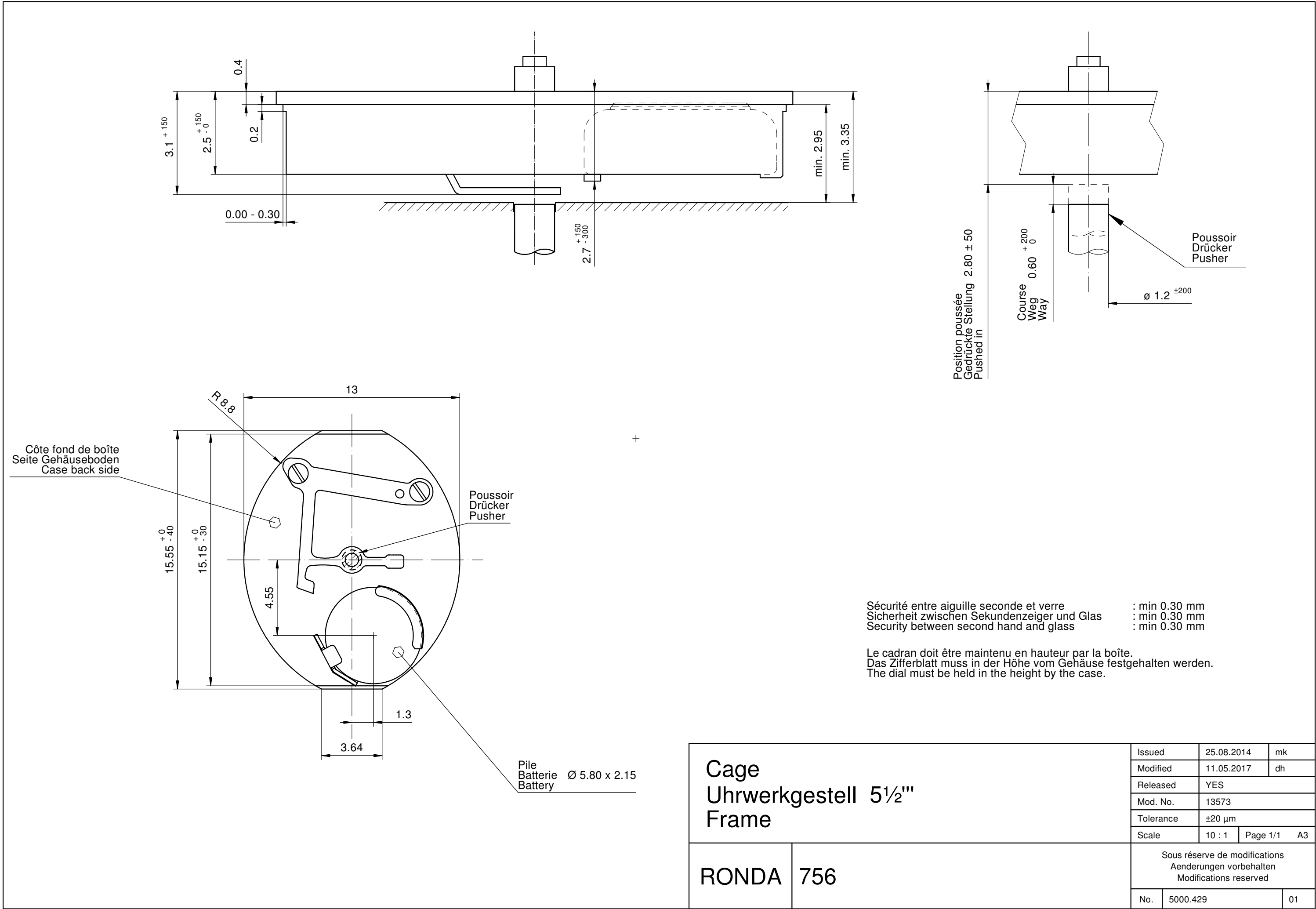

Cage Uhrwerkgestell 5½" Frame		Issued	25.08.2014	mk
		Modified	11.05.2017	dh
		Released	YES	
		Mod. No.	13573	
		Tolerance	±20 µm	
		Scale	10 : 1	Page 1/1 A3
RONDA	756	Sous réserve de modifications Änderungen vorbehalten Modifications reserved		
		No.	5000.429	01

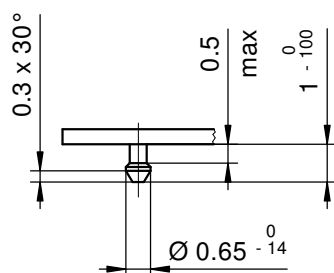
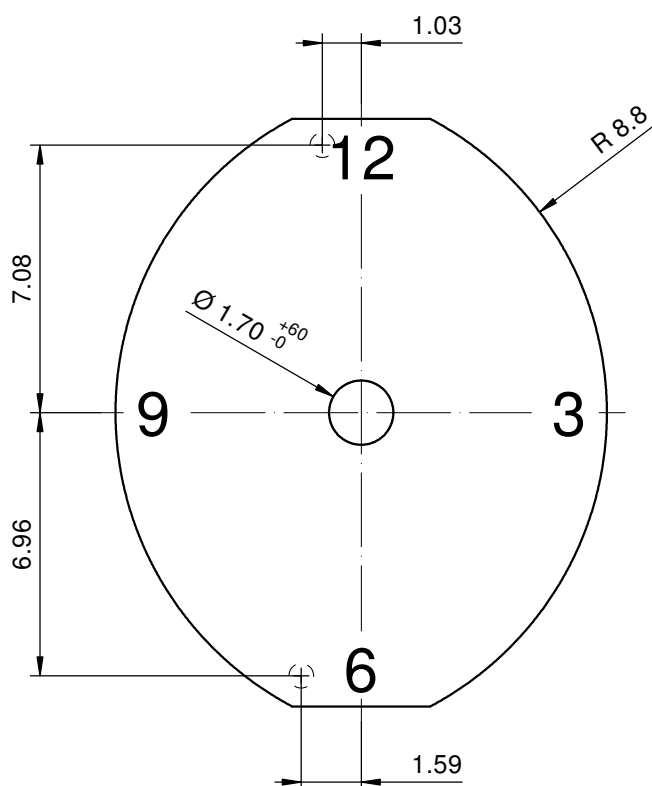

Epaisseur du cadran selon hauteur de l'aiguillage  
Zifferblattdicke gemäss Zeigerwerkhöhen  
Dial thickness according to hand fitting heights

Cadran  
Zifferblatt 5 1/2"  
Dial

Issued	06 Jan 2016	dh
Modified	17 Okt 2016 ÄÄ 13573	dh
Released	YES	
Tolerance	+/- 20 µm	
Scale	5 : 1 (A4V)	

RONDA

756

Sous réserve de modifications  
Änderungen vorbehalten  
Modifications reserved

No.	5010.798	01
-----	----------	----

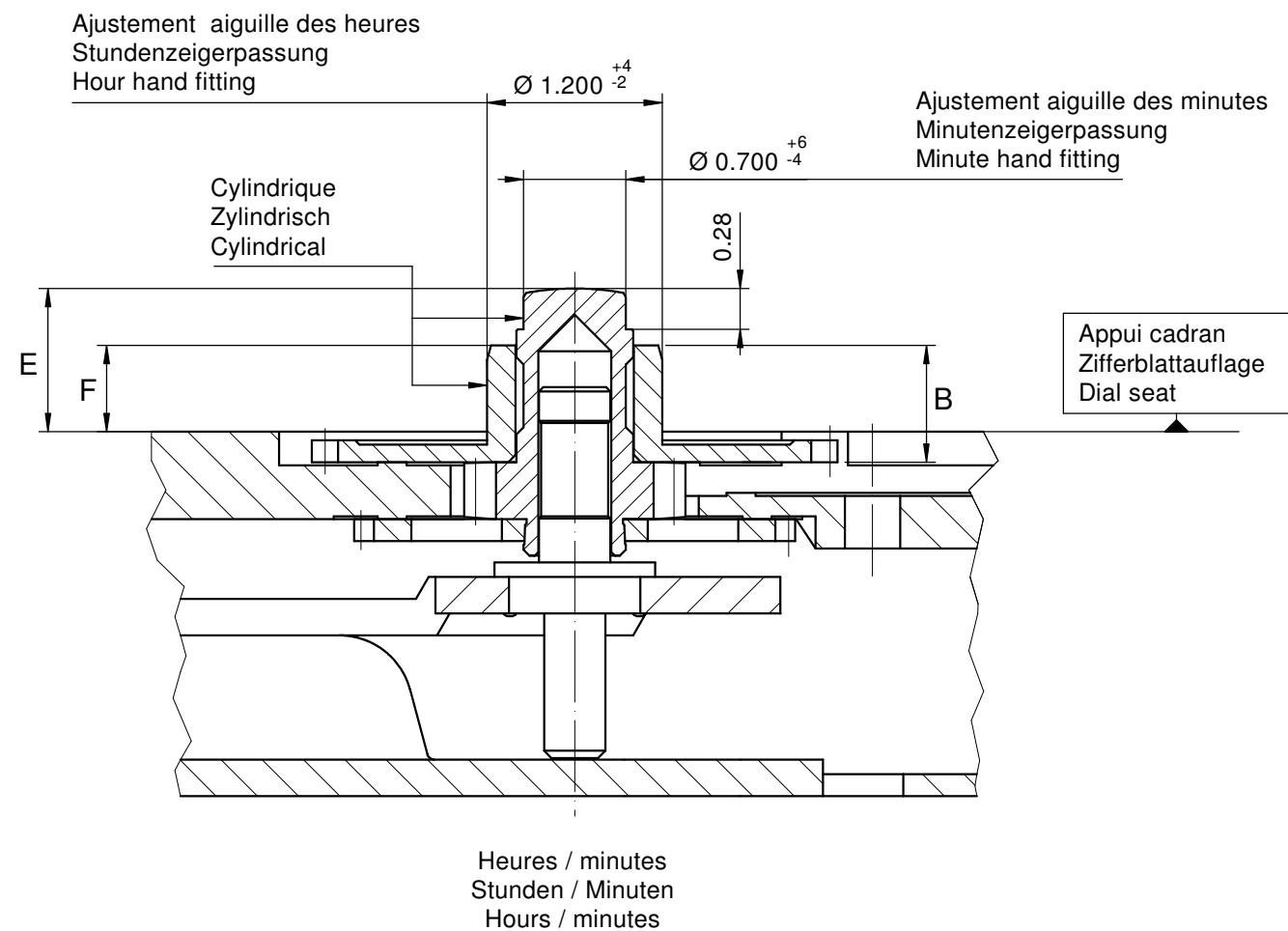

Aiguillage no Zeigerwerkhöhe Nr. Hand fitting height No	Dépassement Höhe über Zifferblattaufgabe Height over dial seat			Longueur Länge Length		Epaisseur max. (peinture comprise) Max. Dicke (inkl. Farbe) Max. thickness (paint included)			
	Chaussée Minutenrohr Cannon-pinion	Roue des heures Stundenrad Hour wheel		Roue des heures Stundenrad Hour wheel		Cadran Zifferblatt Dial			Aiguilles Zeiger Hands
						Sous l'aiguille des minutes Unter Minutenzeiger Under minute hand	Sous l'aiguille des heures Unter Stundenzeiger Under hour hand		
	E	F		B					
0	0.95	0.60		0.80		0.50	0.30		0.15
1	1.10	0.75		0.95		0.65	0.40		0.15
2	1.30	0.95		1.15		0.85	0.60		0.15
3	1.80	1.35		1.57		1.35	1.00		0.15
4	2.70	2.35		2.55		2.25	2.00		0.15
5	3.30	2.95		3.15		2.85	2.60		0.15

		Aig. des minutes Minutenzeiger Minute hand	Aig. des heures Stundenzeiger Hour hand	Lors de la pose d'aiguilles, le mouvement doit être soutenu. Beim Zeigersetzen muss das Werk abgestützt werden. The movement needs to be supported for hand setting.
mg	max.	30	30	Masse / Masse / Weight *
µNm	max.	0.14	0.14	Balourd / Unwucht / Unbalance *
gmm <sup>2</sup>	max.	-	-	Inertie / Massenträgheit / Inertia *
N	max.	40	40	Force de chassage / Aufpresskraft / Force

## Aiguillages Zeigerwerkhöhen 5½", 6¾ x 8" Hand fitting heights

RONDA

751, 756, 762, 762E

Issued	18 Feb 2001	mk
Modified	06 Jan 2016 ÄA 13573	dh
Released	Yes	
Tolerance	µm	
Scale	20 : 1 (A3H)	
Sous réserve de modifications Äenderungen vorbehalten Modifications reserved		
No.	3316.002	20

# User's Manual English

## Movement Caliber

### RONDA normtech

– 756

You have decided to buy a watch, which was assembled by a watchmaker using a Ronda movement. Please note that no watches are produced or distributed under the Ronda brand.

In case of repairs, guarantee claims and questions concerning the functioning of a watch, purchasers and consumers should contact their retailer or the watch manufacturer, for which the relevant information can be found in the sales or guarantee documentation provided with the watch.



**ETS**

**Cal. 756**

#### **ETS – Electronic time setting on case back**

1. brief pressure up to two seconds: minute correction
2. medium pressure between two and four seconds: hour correction
3. Pressure more than four seconds: continuous correction until corrector is released





#### **Cal. 756**

Battery type: 379/SR521SW

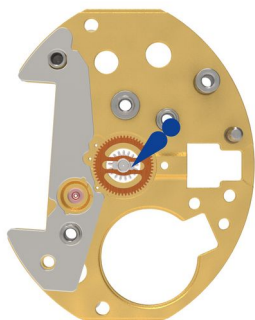

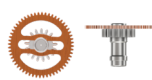

Precision: +20/-10 seconds per month



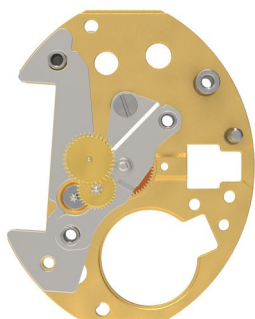



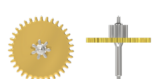

- |   |   |                  |                      |
|---|---|------------------|----------------------|
| 1 |  | 2000.365.SM.G.LC | Main plate           |
| 2 |  | 3622.018         | Stator               |
| 3 |  | 3305.174.CO      | Cannon pinion (Aig.) |
| 4 |  | J124             | Jismaa 124           |

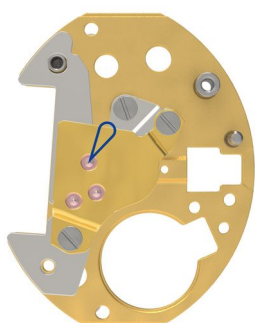

- |   |   |             |                    |
|---|---|-------------|--------------------|
| 5 |    | 2020.104.CO | Center bridge      |
| 6 |    | 4000.141    | Screw              |
| 7 |   | 3715.100.RK | Rotor              |
| 8 |  | 3147.020.CO | Intermediate wheel |
| 9 |  | 3122.045.CO | Third wheel        |



- |    |   |                |                    |
|----|---|----------------|--------------------|
| 10 |  | 2020.116.G.M25 | Train wheel bridge |
| 11 |  | 4000.141       | Screw              |
| 12 |  | 4000.141       | Screw              |
| 13 |  | 9014           | Moebius 9014       |

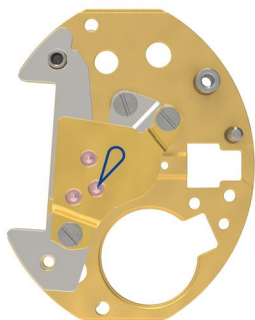

14



9014

Moebius 9014

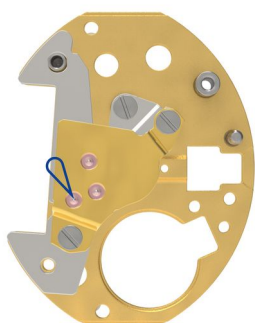

15



9014

Moebius 9014



16



3621.061.RK

Coil

Attention: Please hold the coil only on the grey coil core.

17



3601.039.G

Battery clamp (+)

18



4000.243

Screw





19



9014

Moebius 9014

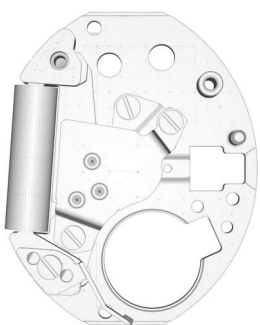

20

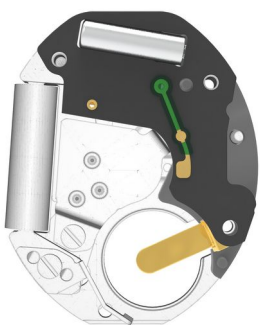

21



3603.103

Insulator

22



3601.047

Contact strip (-)





23



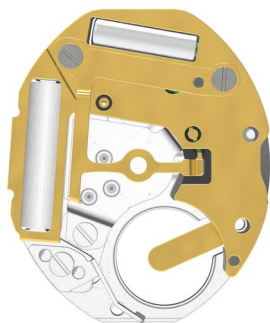

3612.252

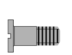
Electronic module







- |    |   |                |                           |
|----|---|----------------|---------------------------|
| 24 |  | 2130.251.G.M01 | Module cover plate        |
| 25 |  | 3601.162.G     | Contact spring for pusher |
| 26 |  | 4000.343       | Screw                     |
| 27 |  | 4000.343       | Screw                     |

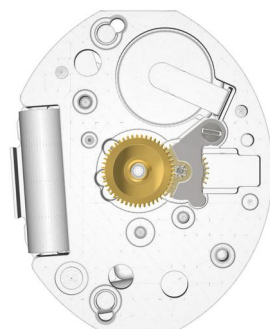

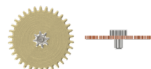
- |    |  |              |                             |
|----|--|--------------|-----------------------------|
| 28 |   | 3600.018.HGF | Battery 379 (Ø 5.80 x 2.15) |
| 29 |   | 3601.171.G   | Battery clamp               |
| 30 |  | 4000.375     | Screw                       |



- |    |   |             |                   |
|----|---|-------------|-------------------|
| 31 |  | 3007.052.CO | Minute wheel      |
| 32 |  | 2130.041    | Plate             |
| 33 |  | 4000.169    | Screw             |
| 34 |  | 3301.133.TA | Hour wheel (Aig.) |
| 35 |  | 3315.001    | Friction spring   |

## Measurement

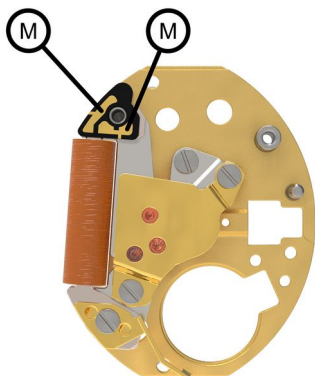

Signal generator (4.9ms, 8Hz)  
< 1.20 V

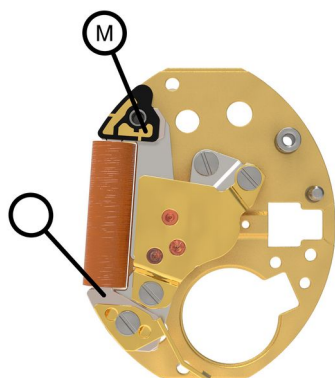

Coil insulation  
infinite

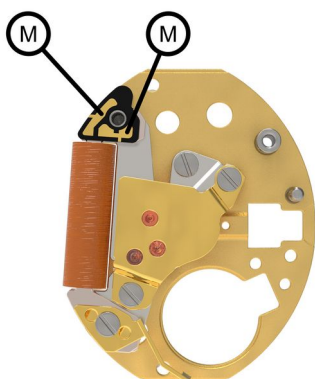

Coil resistance movement  
(min./max) 1425 - 1575 Ohm

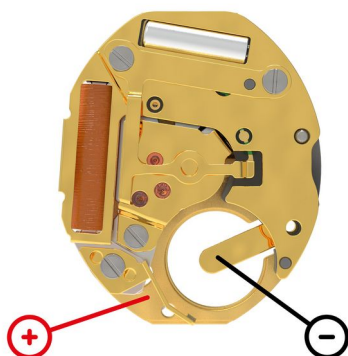

60s measuring interval  
(typ./max.) 0.34 / 0.40  $\mu$ A

60s measuring interval  
-10 .. +20s/mth

Lower working voltage limit  
<1.20 V

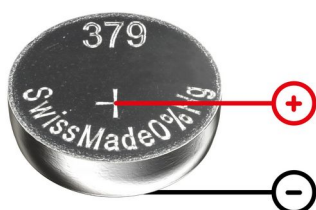

Voltage  
typ. 1.5 V